



DIGGING IN TO BEST PRACTICES

Bore Holes

What you need to know...

Requesting a locate radius, white lining/pre-marking, and providing an additional detailed site plan are the recommended Best Practice.

Why you want to do this...

Communication between excavator and Member/Locate Service Provider is the best avenue to a timely and successful locate.

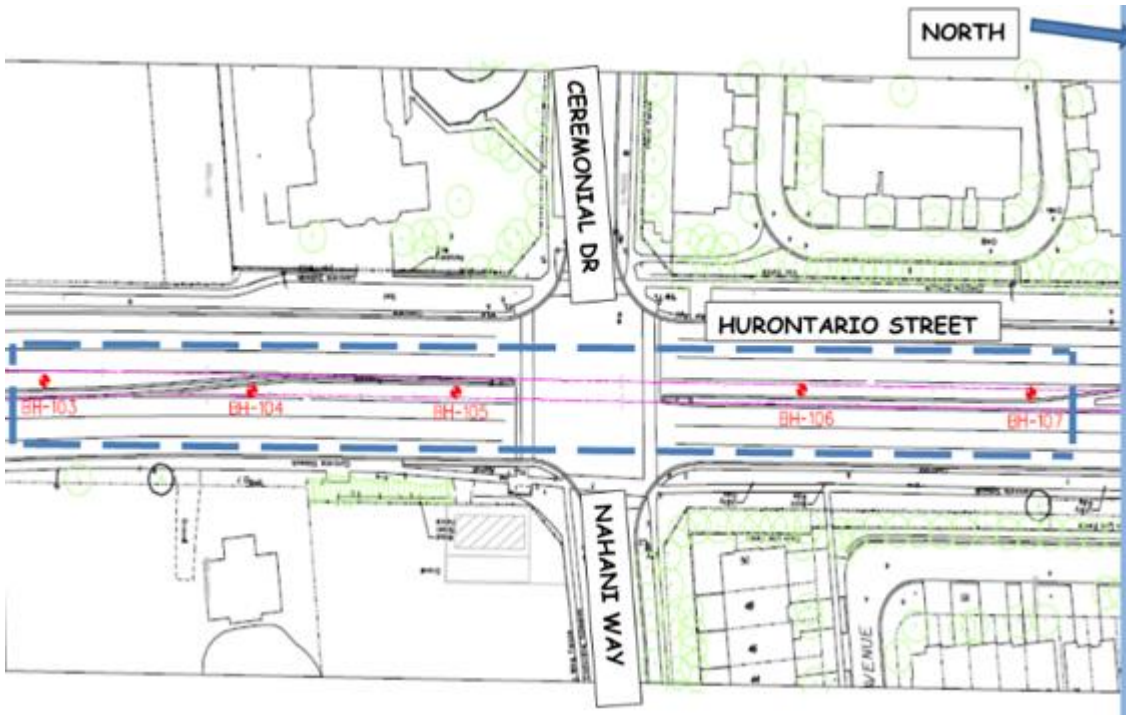

Our recommended Best Practices for Bore Holes:

Provide a detailed description of your work. Use a geographical reference when a civic address is not available and include distance and direction from the nearest intersection if applicable.

Pre-mark the site with white paint and/or flags. Request a radius around the proposed bore hole location to allow for movement if there is conflicting underground infrastructure.

OR arrange for a site meet. If you are arranging a site meet, try to get everyone together at the same time. That way, if there are any underground conflicts, moving the borehole location is easier.

In addition to the map selection, providing a detailed site plan with your proposed bore hole locations may increase clearances and improve response times.

Please ensure that your map selections are on or parallel to the dig street you identified in the Dig Location section and the map selections fall between the two cross streets you provided. If required, you may override the system by manually typing in the correct street names after you have saved and attached your map selection.



Please ensure you are referencing the most recent version of this document. Version 1.2

Available 24/7

OntarioOneCall.ca | 1-800-400-2255